

ADVANCE ADAPTERS INC.

4320 Aerotech Center Way

Paso Robles, CA 93447

Telephone: (800) 350-2223

Fax: (805) 238-4201

P/N: 713028-EK

PAGE 1 OF 2

Page Rev. Date: 3/1/24

TOYOTA LAND CRUISER 3 SPEED TRANSMISSION TO CHEVY V8 ENGINE

KIT CONSISTS OF:

No.	Qty	Part No.	Description
1.	1 Kit	712523	TOYOTA 3 SPEED ADAPTER
2.	1 Kit	713124	ENGINE MOUNTS
3.	1 Kit	716022	REAR T/C CROSSMEMBER
4.	1	716023	WATER TEMP. BUSHING
5.	1	716024	VACUUM T/C SHIFT PIVOT
6.	1	716176	CLUTCH RELEASE LEVER
7.	1	716176SC	THROW-OUT LEVER SPRING CLIP
8.	1 Kit	716287	SLAVE CYLINDER BRACKET
9.	1 Kit	716316	THROW-OUT BEARING

OPTIONAL ITEMS:

Qty	Part No.	Description
1	CF165473S	11" SPEC. PRESSURE PLT.
1	383735	11" CLUTCH DISC.
1	717006	EXHAUST HEADERS
1	717011	HEADERS
1	716078	4.686 TO 5.125 BELLHOUSING INDEX BUSHING

INSTALLATION PROCEDURES:

This conversion will require driveshaft modifications and will require the use of a Chevy aluminum bellhousing that has the small 4.686" index diameter. The Toyota instruction manual must be used for detailed information concerning the engine conversion.

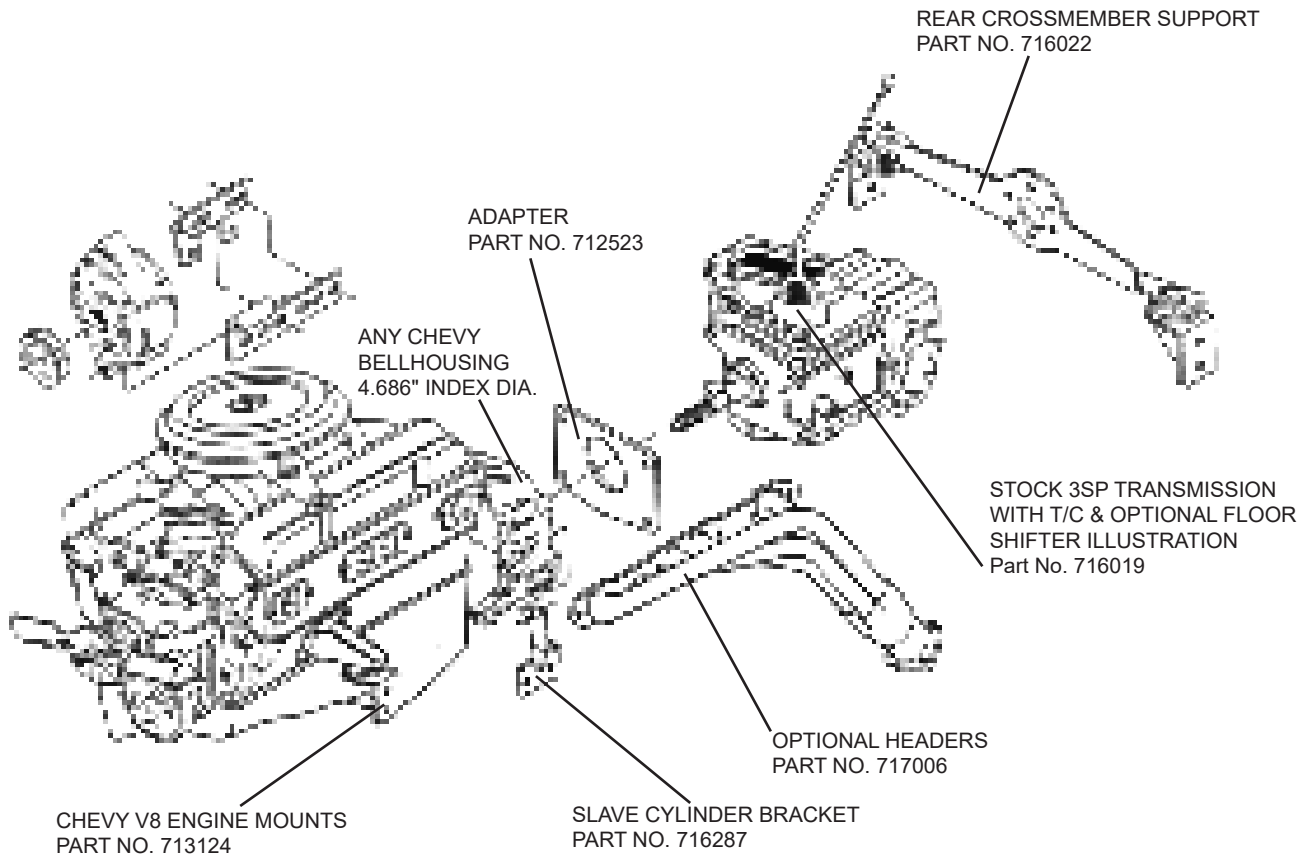

SPECIAL NOTE: The components packaged in this kit have been assembled and machined for specific type of conversions. Modifications to any of the components will void any possible warranty or return privileges. If you do not fully understand modifications or changes that will be required to complete your conversion, we strongly recommend that you contact our sales department for more information. This instruction sheet is only to be used for the assembly of Advance Adapter components. We recommend that a service manual pertaining to your vehicle be obtained for specific torque values, wiring diagrams and other related equipment. These manuals are normally available at automotive dealerships and parts stores.

ADVANCE ADAPTERS INC.

4320 Aerotech Center Way

Paso Robles, CA 93447

Telephone: (800) 350-2223

Fax: (805) 238-4201

P/N: 713028-EK

PAGE 2 OF 2

Page Rev. Date: 3/1/24

TOYOTA LAND CRUISER 3 SPEED TRANSMISSION TO CHEVY V8 ENGINE

The new pivot ball needs to be installed into the bellhousing. Apply blue Loctite to the threads and torque to 40-45 ft-lbs. The clutch fork will need the spring clip installed; a pair of needle nose pliers works well. Once the spring clip is installed, apply grease to the spring and socket of the fork.

*Note: Clutch fork must be installed into the bellhousing before bolting to the engine.

Place the fork over the pivot ball, centering the spring clip. With a dead blow hammer, hit the back side of the fork using ample force, directly perpendicular to the pivot ball (2 or 3 times may be required). Fork should move free, with slight resistance. If not, repeat the force with the dead blow hammer.

See photos



SPECIAL NOTE: The components packaged in this kit have been assembled and machined for specific type of conversions. Modifications to any of the components will void any possible warranty or return privileges. If you do not fully understand modifications or changes that will be required to complete your conversion, we strongly recommend that you contact our sales department for more information. This instruction sheet is only to be used for the assembly of Advance Adapter components. We recommend that a service manual pertaining to your vehicle be obtained for specific torque values, wiring diagrams and other related equipment. These manuals are normally available at automotive dealerships and parts stores.