



P.O. Box 247, 4320 Aerotech Center Way
Paso Robles, CA 93447
Telephone: (800) 350-2223 Fax: (805) 238-4201
PAGE 1 OF 2 Page Rev. Date: 11-14-23
P/N: 50-9904

Jeep JL & JT DIESEL 8-Speed Automatic to ATLAS

KIT CONSISTS OF:

No.	Qty	Part No.	Description
1	51-9900	850RE	8-Speed AT & DODGE 8HP870 8-Speed TO ATLAS
1	52-9904	SHAFT-	JEEP 23 FEMALE X JEEP 23 MALE 6.9" OAL.
1	716308	SEALED BEARING	209RS
1	716450	SNAP RING (T350 & T400)	
1	716456	TRUE ARC SNAP RING	

Jeep JL & JT Diesel 8 speed automatic to Atlas 2 speed: The Jeep JL with the diesel 8-speed automatic is coupled to a Magna transfer case. Jeep went away from its standard circular bolt pattern when coupling these two gear boxes. So this required us to manufacture a new adapter housing to couple the Atlas to the 8 speed automatic. **P/N 50-9904** adapts the diesel 8 speed automatic to a Atlas 23 spline standard input. The 7.75" adapter also provides the needed length to clear the transmission cooling system.

On these applications Jeep used a short adapter housing between the stock transfer case and the auto transmission. Our adapter kit will retain this stock adapter and coupling the this transmission to the adapter kit. The adapter will retain the stock transmission support which bolts to the new adapter housing.

We offer a new yoke to retain the stock GKN driveshafts **P/N AFJL**. The adapter puts the Atlas in a similar location as factory, allowing you to retain the factory driveshafts. These yokes can be swapped out for any Spicer yoke down the road, but it now allows the Jeep equipped Atlas to be back on the road within a day. The complete install of the transfer case is approximately 6 hours and the shifter 1 to 2 hours. The Atlas should be built with a **23 spline standard input**.

Installation notes: Removed the stock transfer case. Support the stock drivetrain up by the transmission as you will need to remove the transmission crossmember and skid pan. After the skid pan is removed, you should be able to remove the driveshafts from the stock transfer case. If retaining the stock driveshafts, these can be left connected to the axles.

Remove the crossmember and then unbolt and remove the transfer case. Note: If you are able to lower the rear side of the drivetrain a bit, it will provide better access to the transfer case to transmission bolts. The stock transfer case shifter linkage also needs to be removed.

Install the new adapter housing using the factory bolts. We recommend not connecting the crossmenber back to the frame until the Atlas is installed. The bolts that are closest to the floorboard are hard to tighten if the drivetrain is back in the stock position.

Note: The stock transfer case breather need to be removed and installed on the Atlas. The Atlas is shipped with a red cap that covers the elbow that the breather should be connected to.

SPECIAL NOTE: The components packaged in this kit have been assembled and machined for specific type of conversions. Modifications to any of the components will void any possible warranty or return privileges. If you do not fully understand modifications or changes that will be required to complete your conversion, we strongly recommend that you contact our sales department for more information. This instruction sheet is only to be used for the assembly of Advance Adapter components. We recommend that a service manual pertaining to your vehicle be obtained for specific torque values, wiring diagrams and other related equipment. These manuals are normally available at automotive dealerships and parts stores.

Jeep JL & JT 850RE-8 Speed and Dodge Trucks w/ an 8HP70 8 speed, to Atlas

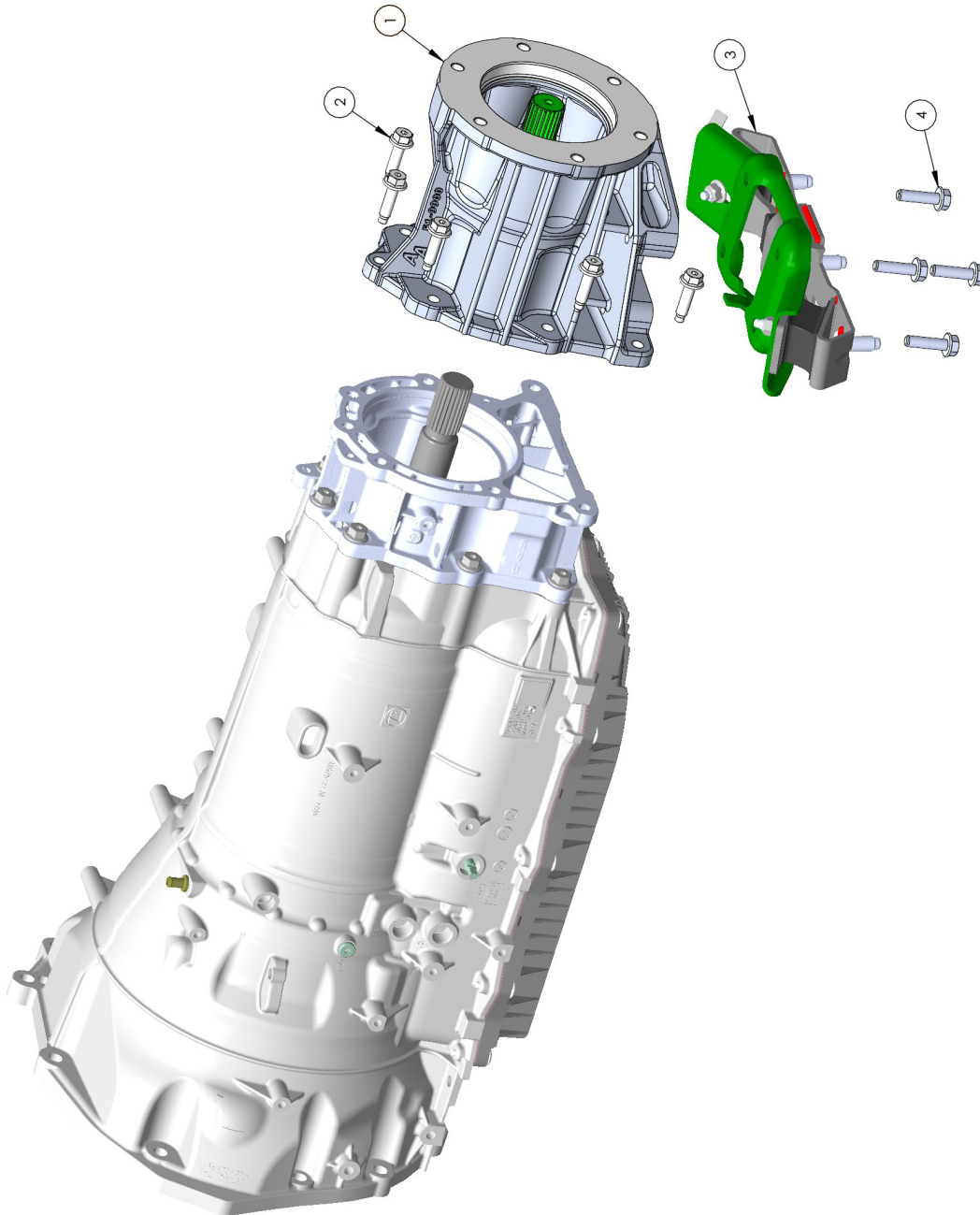

SPECIAL NOTE: The components packaged in this kit have been assembled and machined for specific type of conversions. Modifications to any of the components will void any possible warranty or return privileges. If you do not fully understand modifications or changes that will be required to complete your conversion, we strongly recommend that you contact our sales department for more information. This instruction sheet is only to be used for the assembly of Advance Adapter components. We recommend that a service manual pertaining to your vehicle be obtained for specific torque values, wiring diagrams and other related equipment. These manuals are normally available at automotive dealerships and parts stores.