

FORD T98 4-SPEED TRANSMISSION TO JEEP DANA 300 TRANSFER CASE

KIT CONSISTS OF:

No.	Qty	Part No.	Description
1.	1	51-7502	ADAPTER CASTING
2.	1	52-7502	T98 MAIN SHAFT
3.	1	716452	SNAP RING (<i>Jeep #8132631</i>)
4.	1	716517	GASKET (<i>Dana 300</i>)
5.	1	716722	SEAL (<i>National #472319</i>)
6.	2	723723	H.H.C.S. 3/8"-16 x 1-1/2"
7.	2	723728	S.H.C.S. 3/8"-16 x 2-1/2"
8.	2	723735	FLAT WASHER 3/8" STD.
9.	2	724328	H.H.C.S. 7/16"-14 x 1-1/4"
10.	1	SPECIAL	2ND GEAR

*Before assembly of the transmission with the new main shaft, you must verify that the correct shaft is being used. Your spline count on the shaft must be 23-splines. We also manufacture a 27-spline shaft that **will not** be compatible with your Dana 300 transfer case.*

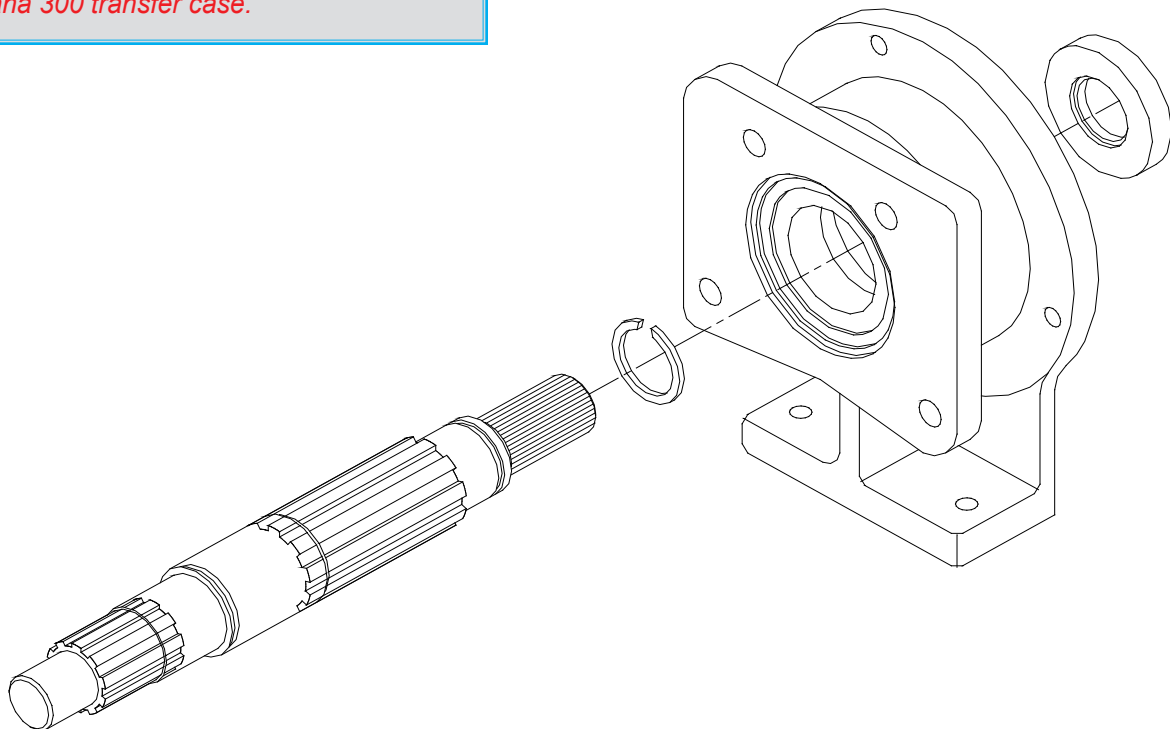

SPECIAL NOTE: The components packaged in this kit have been assembled and machined for specific type of conversions. Modifications to any of the components will void any possible warranty or return privileges. If you do not fully understand modifications or changes that will be required to complete your conversion, we strongly recommend that you contact our sales department for more information. This instruction sheet is only to be used for the assembly of Advance Adapter components. We recommend that a service manual pertaining to your vehicle be obtained for specific torque values, wiring diagrams and other related equipment. These manuals are normally available at automotive dealerships and parts stores.



P.O. Box 247, 4320 Aerotech Center Way
Paso Robles, CA 93447
Telephone: (800) 350-2223 Fax: (805) 238-4201
PAGE 2 OF 3 Page Rev. Date: 09-26-16
P/N: 50-7503

FORD T98 4-SPEED TRANSMISSION TO JEEP DANA 300 TRANSFER CASE

WARNER T98 4 SPEED 1966 & UP:

The T98 transmission can be identified by a case length of 11-7/8". The shift cover has a casting number of 13-01 or 13-09. The P.T.O. opening is on the right hand side towards the front of the case and the shift cover is mounted to the top of the case with six bolts.

The assembled length of the transmission and adapter will vary depending on which installation you are doing. On certain Jeep applications, we have set the length up to be an exact replacement of the original T4 and T5 transmissions. This adapter is designed to fit the Jeep version of the T98 4-speed. The difference between the Jeep and the Ford T98 is the bolt patterns on both the front and back of the 4-speed. The main shafts are identical. The casting in this kit for the Jeep T98 is the same casting we use with the Ford T98, except it is machined differently for your transmission. The Jeep T98 uses a 6 hole bolt pattern on the back of the transmission. We've attempted to utilize as many of the stock holes as possible to fasten this adapter casting to your 4-speed. However, the lower two holes are not accessible to use with our adapter housing. Therefore, some machining is required on your 4-speed transmission in order to use this adapter.

Before you begin to assemble your transmission, you must make sure that you have received the correct main shaft. The new shaft furnished with this kit must be carefully compared to the original shaft removed from your transmission. The spline on the end of the shaft must have 23 teeth. We manufacture two different T98 main shafts and it is possible that you could receive the 27 spline in error.

While the main shaft is still in your transmission, set the A/A transfer case adapter onto the back of your transmission. The adapter should index onto the rear output shaft bearing. This will align the adapter to your transmission. Install the top two fasteners from the adapter to the T98 to make sure the rotation is correct. The purpose of this is to locate a position for the new holes that need to be drilled into your Jeep T98. With the casting fastened to the T98, use either a marking pen or a metal scribe to mark the center of the lower two holes using the casting as a template. Once the holes are marked, remove the casting and the main shaft out of the transmission. Using a drill press or a mill, drill and tap the two holes marked on your T98 transmission (3/8"-16 is recommended). **Care should be taken to keep the inside of the case as clean as possible from chips of metal and dirt.**

When assembling the gears onto the new main shaft, make sure that all gears have the proper end clearance required for oiling. Make sure that all transmission assembly work is done by a competent mechanic. Warner gear has used two different shaft designs for the spacer between second and third gear. Some transmissions will use a snap ring and thrust washer, while others will use a built in shoulder. Both shafts are interchangeable. Install the new main shaft and gear assembly into the Jeep T98 case.

The new seal provided with the adapter kit must be installed with the open side towards the transmission. The casting will need to be installed on the T98. Use a small bead of RTV Blue Silicon on the backside of your transmission and on the threads of the socket head bolts. Locate the adapter onto the back bearing for indexing. Install the top two and new bottom two bolts and tighten. Insert the two socket head bolts into the middle two holes and tighten. **NOTE: The two socket head bolts will protrude slightly into the inside of the transmission case. Make sure they don't interfere with the gear. Shorten bolts if necessary.**

The skid plate will need to be slightly modified to fit under the new transmission. Two new holes may be necessary for use with the new adapter and a slight notch may be required on the front leading edge of the skid plate for clearance around the front driveshaft.

When this transmission is going to be used with an AMC 6 cylinder or V8 engine, you must use Jeep bellhousing #8133951, and Advance Adapters pilot bushing P/N 716156. The clutch disc should be changed to a 10-1/2", Centerforce No. 384180.

SPECIAL NOTE: The components packaged in this kit have been assembled and machined for specific type of conversions. Modifications to any of the components will void any possible warranty or return privileges. If you do not fully understand modifications or changes that will be required to complete your conversion, we strongly recommend that you contact our sales department for more information. This instruction sheet is only to be used for the assembly of Advance Adapter components. We recommend that a service manual pertaining to your vehicle be obtained for specific torque values, wiring diagrams and other related equipment. These manuals are normally available at automotive dealerships and parts stores.

FORD T98 4-SPEED TRANSMISSION TO JEEP DANA 300 TRANSFER CASE

FORD & JEEP T98 4-SPD TRANS.
CASE LENGTH: 11.875"

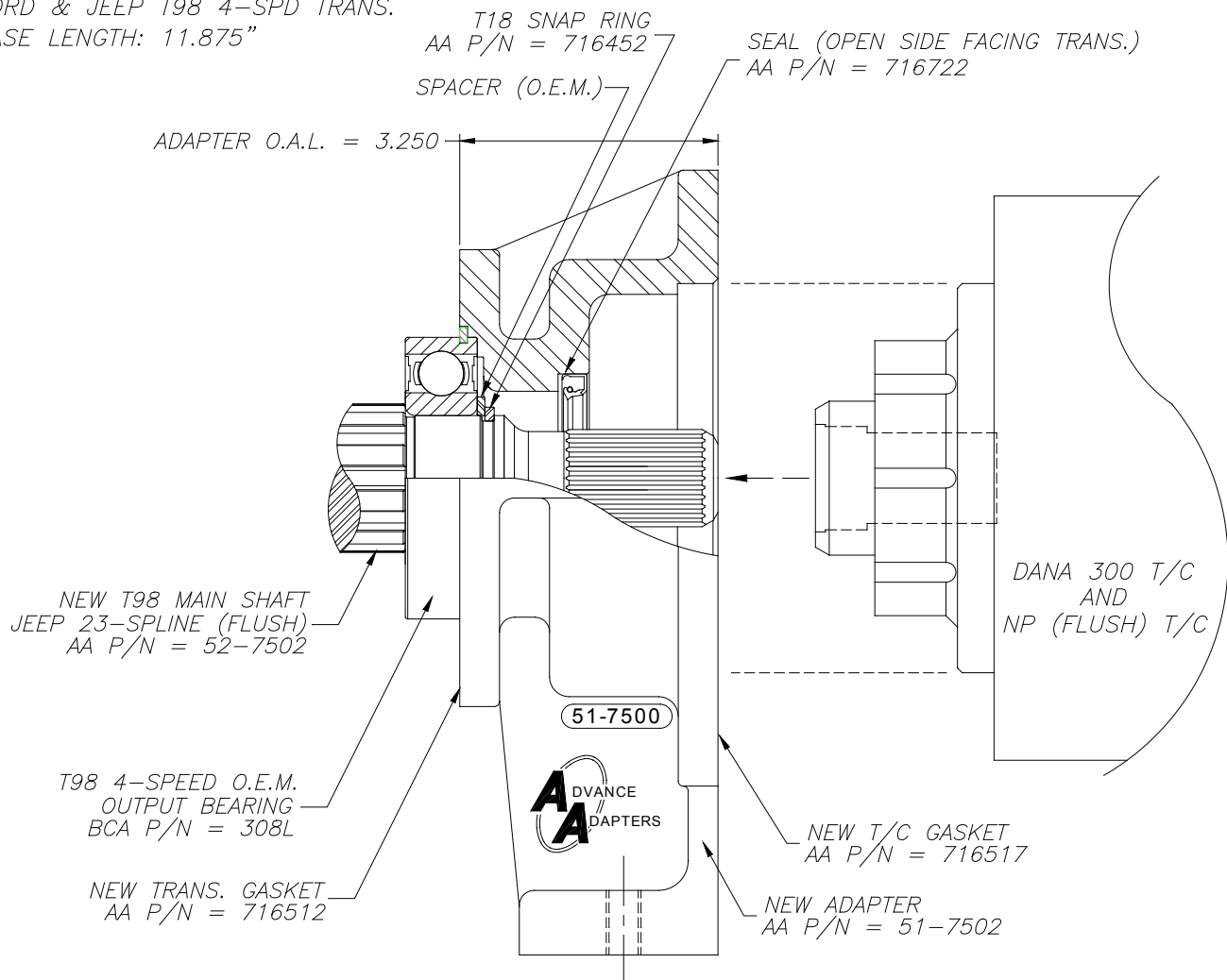

SPECIAL NOTE: The components packaged in this kit have been assembled and machined for specific type of conversions. Modifications to any of the components will void any possible warranty or return privileges. If you do not fully understand modifications or changes that will be required to complete your conversion, we strongly recommend that you contact our sales department for more information. This instruction sheet is only to be used for the assembly of Advance Adapter components. We recommend that a service manual pertaining to your vehicle be obtained for specific torque values, wiring diagrams and other related equipment. These manuals are normally available at automotive dealerships and parts stores.