

ADVANCE ADAPTERS INC.

P.O. Box 247, 4320 Aerotech Center Way

Paso Robles, CA 93447

Telephone: (800) 350-2223 Fax: (805) 238-4201

P/N: 716134

PAGE 1 OF 1

Page Rev. Date: 09-24-02

CHEVY BELLHOUSING TO BUICK ENGINE BLOCKS

KIT CONSISTS OF:

No.	Qty	Part No.	Description
1.	1	716134-BLK	STEEL PLATE
2.	6	723115	SPECIAL FLAT WASHERS
3.	6	723122	5/16" FLAT WASHERS
4.	3	723704	3/8" LOCK WASHERS
5.	4	723718	3/8"-16 x 1" F.H.C.S.
6.	3	723721	3/8"-16 x 1" H.H.C.S.
7.	2	723723	3/8"-16 x 1-1/2" H.H.C.S.
8.	3	723732	3/8"-24 x 1" H.H.C.S.

INSTALLATION INSTRUCTIONS:

The stock converter will need to be spaced back from the flexplate using (2) 3/8" flat washers on each bolt. Three places on the flexplate use hex head cap screws (3/8"-24 x 1") with nuts and lock washers.

THE STEEL PLATE BOLTS TO THE BLOCK USING FLATHEAD SCREWS. THEN THE BELLHOUSING OR TRANSMISSION BOLTS BACK TO STEEL PLATE.

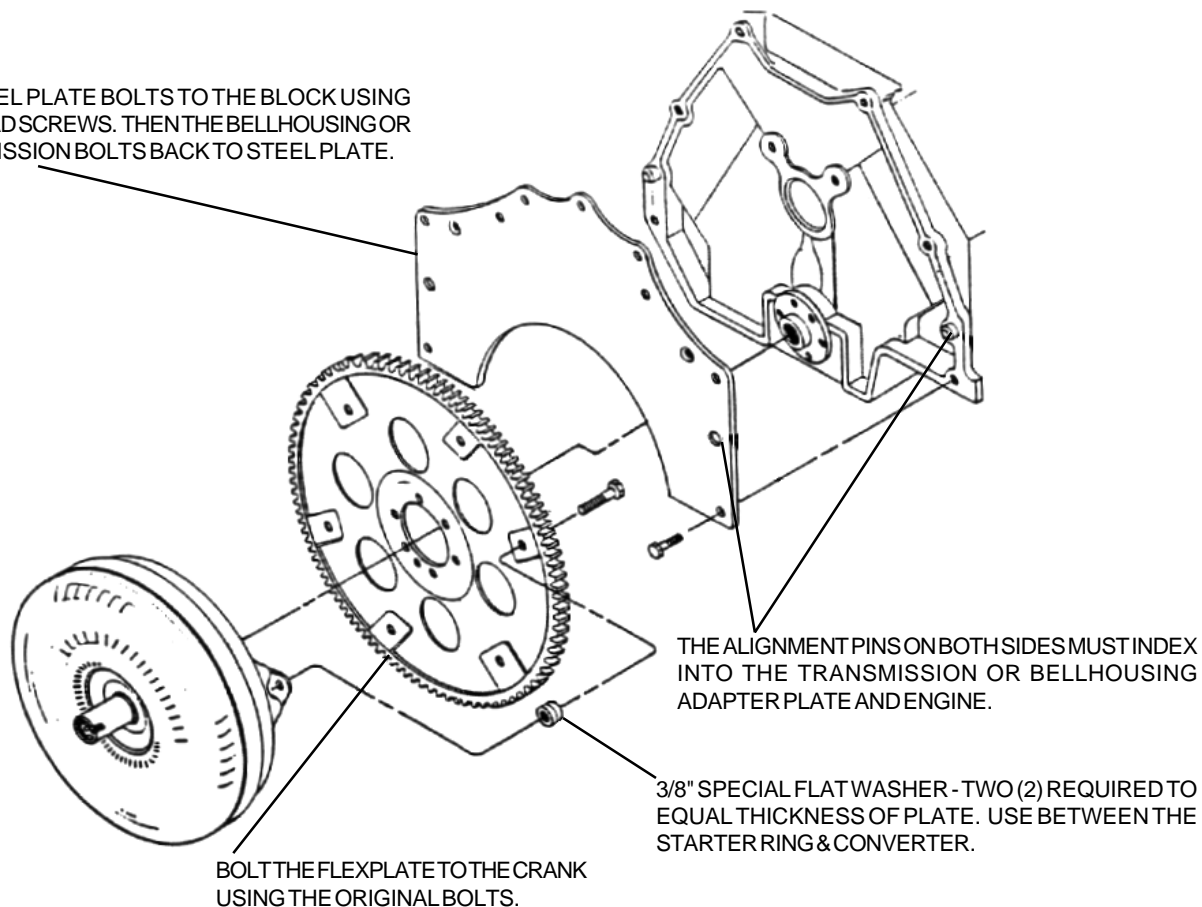

SPECIAL NOTE: The components packaged in this kit have been assembled and machined for specific type of conversions. Modifications to any of the components will void any possible warranty or return privileges. If you do not fully understand modifications or changes that will be required to complete your conversion, we strongly recommend that you contact our sales department for more information. This instruction sheet is only to be used for the assembly of Advance Adapter components. We recommend that a service manual pertaining to your vehicle be obtained for specific torque values, wiring diagrams and other related equipment. These manuals are normally available at automotive dealerships and parts stores.