



P.O. Box 247, 4320 Aerotech Center Way  
Paso Robles, CA 93447  
Telephone: (800) 350-2223 Fax: (805) 238-4201  
PAGE 1 OF 4 Page Rev. Date: 03-13-17  
P/N: 50-5707

## TOYOTA R150F 5 SP (V6 & TURBO CHARGE 4 CLY) TO GEAR DRIVEN 23 SPL. TOYOTA 4WD T/C

### KIT CONSISTS OF:

\*This kit will not fit the Toyota Tacoma

No.	Qty	Part No.	Description
1.	1	51-5708	ADAPTER PLATE
2.	1	52-5943	COUPLER- 23T TO 23T TOYOTA
3.	1	716248	ALUM SLEEVE FOR TOYOTA SEAL 21 & 23 SPLINE
3.	1	716720	SEAL FOR ALUM EXTENTION HOUSING
5.	2	720030	10mm X 1.25 X 30mm LONG (Bottom bolts to gear driven box)
6.	4	720087	10mm X 1.25 X 40mm LONG (Top 4 bolts to the gear driven box)

### NOTES

1. This adapter kit is only compatible with 23 tooth input gears. If you are attempting to use a 21 spline transfer case, you will need to change the kit to 50-5708.
2. The adapter kit is only compatible with a transfer case that is top shifted. If the transfer case does not have a shifter included, you must make the necessary changes to have the transfer case accept a top shifter.
3. Remove the chain drive transfer case from the R150 5 speed transmission. The input of the transfer case reaches deep into the 5 speed tailhousing to couple to the transmission output shaft. Once the stock transfer case is removed, you will see a seal that is housed in the 5 speeds tailhousing, this seal needs to be remove
4. The new coupler will need to be installed onto the 5 speed output shaft as illustrated in the drawing. It would be a good idea to inspect and check the fit of the new sleeve onto the transfer case 23 spline input shaft.
5. With the coupler on the transmission output, assemble the new seal from the kit into the aluminum sleeve as shown on the drawing. This sleeve then need to be pressed in the 5 speed tailhousing were the stock seal was just removed. When the sleeve is in place you will not be able to remove the coupler without removing the aluminum sleeve.

**SPECIAL NOTE:** The components packaged in this kit have been assembled and machined for specific type of conversions. Modifications to any of the components will void any possible warranty or return privileges. If you do not fully understand modifications or changes that will be required to complete your conversion, we strongly recommend that you contact our sales department for more information. This instruction sheet is only to be used for the assembly of Advance Adapter components. We recommend that a service manual pertaining to your vehicle be obtained for specific torque values, wiring diagrams and other related equipment. These manuals are normally available at automotive dealerships and parts stores.

## TOYOTA R150F 5 SP (V6 & TURBO CHARGE 4 CLY) TO GEAR DRIVEN 23 SPL. TOYOTA 4WD T/C

6. Bolt the adapter plate to the new gear driven transfer case using RTV silicone between the surfaces. The two shorter bolts go in to the two lower holes on the transfer case.
7. The new transfer case can now be test fitted to the 5 speed. The lower right side (passenger side) bolt will interfere with the 5 speed tailhousing slightly. The photos show the modifications needed to the tailhousing. The lower transmission dowel pin also needs to be checked and possible shortened as it could protrude into the transfer case lower bearing race.

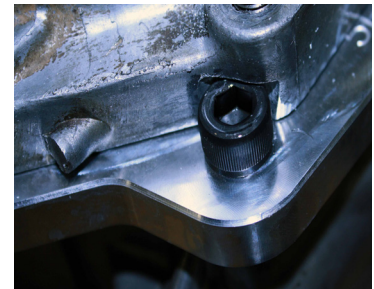

Set the adapter plate up to the 5 speed tailhousing and mark the housing where it interferes with the socket bolt head. Grind the 5 speed housing to obtain clearance.



8. Once the tailhousing is clearance and dowel pin is checked, apply RTV silicone to the bolting surface and use the stock fasteners to bolt the new transfer case to the 5 speed.

**SPECIAL NOTE:** The components packaged in this kit have been assembled and machined for specific type of conversions. Modifications to any of the components will void any possible warranty or return privileges. If you do not fully understand modifications or changes that will be required to complete your conversion, we strongly recommend that you contact our sales department for more information. This instruction sheet is only to be used for the assembly of Advance Adapter components. We recommend that a service manual pertaining to your vehicle be obtained for specific torque values, wiring diagrams and other related equipment. These manuals are normally available at automotive dealerships and parts stores.

**TOYOTA R150F 5 SP (V6 & TURBO CHARGE 4 CLY)  
TO GEAR DRIVEN 23 SPL. TOYOTA 4WD T/C**

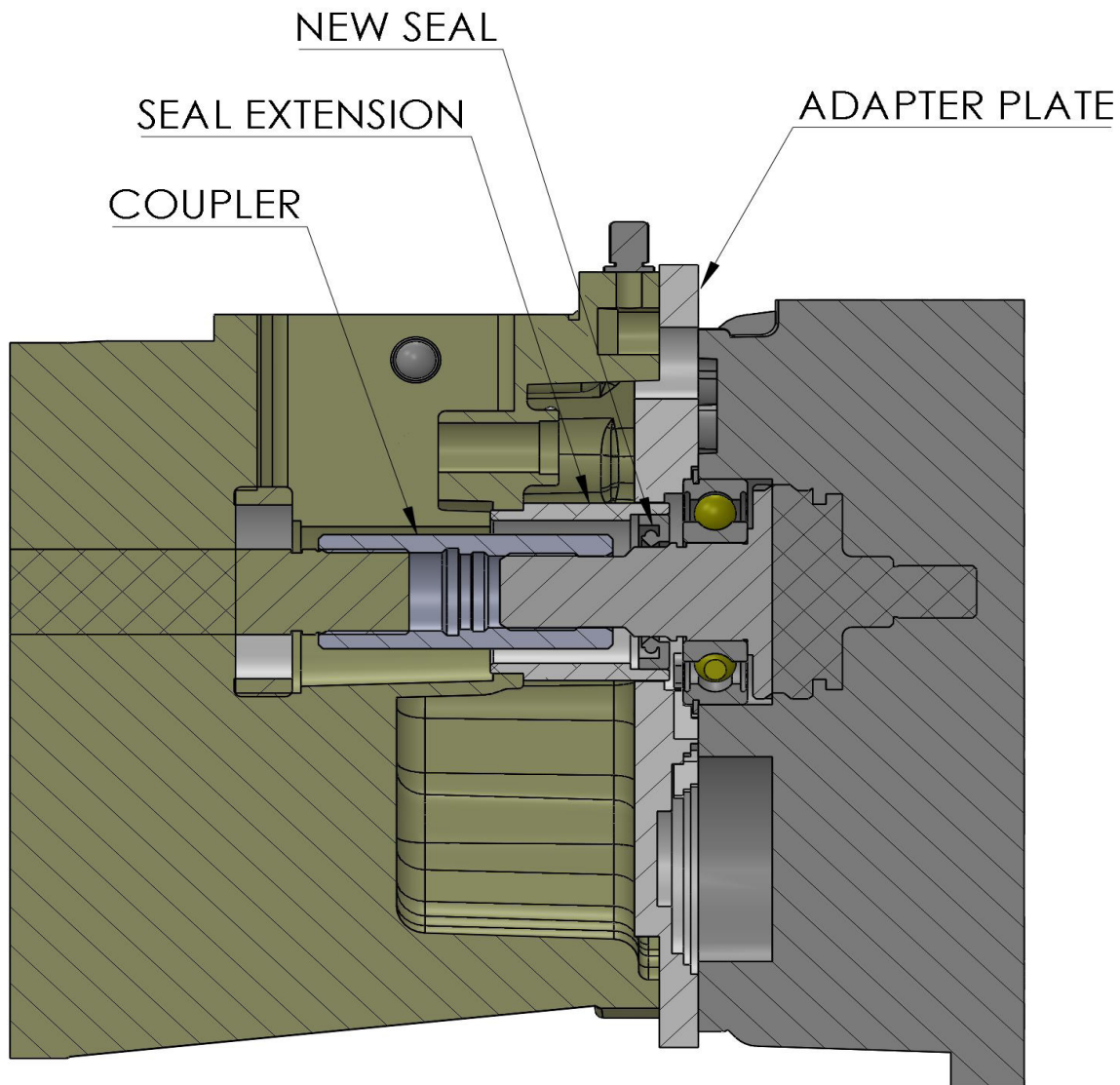

SECTION A-A

**SPECIAL NOTE:** The components packaged in this kit have been assembled and machined for specific type of conversions. Modifications to any of the components will void any possible warranty or return privileges. If you do not fully understand modifications or changes that will be required to complete your conversion, we strongly recommend that you contact our sales department for more information. This instruction sheet is only to be used for the assembly of Advance Adapter components. We recommend that a service manual pertaining to your vehicle be obtained for specific torque values, wiring diagrams and other related equipment. These manuals are normally available at automotive dealerships and parts stores.

**TOYOTA R150F 5 SP (V6 & TURBO CHARGE 4 CLY)  
TO GEAR DRIVEN 23 SPL. TOYOTA 4WD T/C**

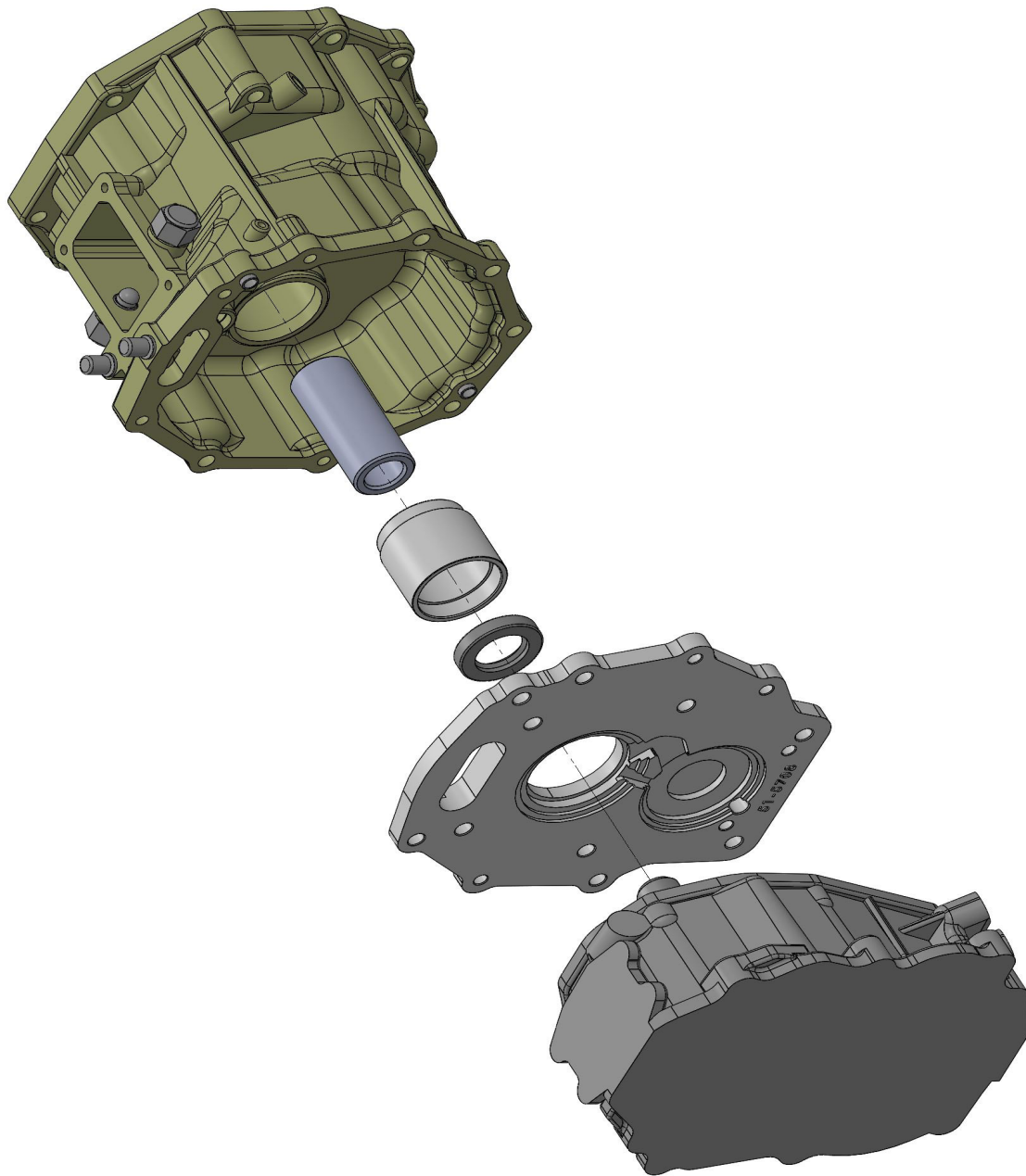

**SPECIAL NOTE:** The components packaged in this kit have been assembled and machined for specific type of conversions. Modifications to any of the components will void any possible warranty or return privileges. If you do not fully understand modifications or changes that will be required to complete your conversion, we strongly recommend that you contact our sales department for more information. This instruction sheet is only to be used for the assembly of Advance Adapter components. We recommend that a service manual pertaining to your vehicle be obtained for specific torque values, wiring diagrams and other related equipment. These manuals are normally available at automotive dealerships and parts stores.